

BYLAW NUMBER 43D2023

**BEING A BYLAW OF THE CITY OF CALGARY
TO AMEND THE LAND USE BYLAW 1P2007
(LAND USE AMENDMENT
LOC2022-0182/CPC2023-0079)**

WHEREAS it is desirable to amend the Land Use Bylaw Number 1P2007 to change the land use designation of certain lands within the City of Calgary;

AND WHEREAS Council has held a public hearing as required by Section 692 of the Municipal Government Act, R.S.A. 2000, c.M-26 as amended;

NOW, THEREFORE, THE COUNCIL OF THE CITY OF CALGARY ENACTS AS FOLLOWS:

1. The Land Use Bylaw, being Bylaw 1P2007 of the City of Calgary, is hereby amended by deleting that portion of the Land Use District Map shown as shaded on Schedule "A" to this Bylaw and replacing it with that portion of the Land Use District Map shown as shaded on Schedule "B" to this Bylaw, including any land use designation, or specific land uses and development guidelines contained in the said Schedule "B".
2. This Bylaw comes into force on the date it is passed.

READ A FIRST TIME ON APRIL 04, 2023

READ A SECOND TIME ON APRIL 04, 2023

READ A THIRD TIME ON APRIL 04, 2023

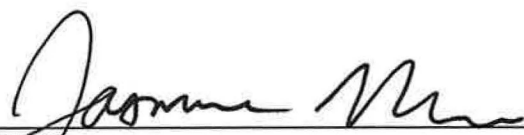
for MAYOR
SIGNED ON APRIL 04, 2023



for CITY CLERK
SIGNED ON APRIL 04, 2023

AMENDMENT LOC2022-0182/CPC2023-0079
BYLAW NUMBER 43D2023

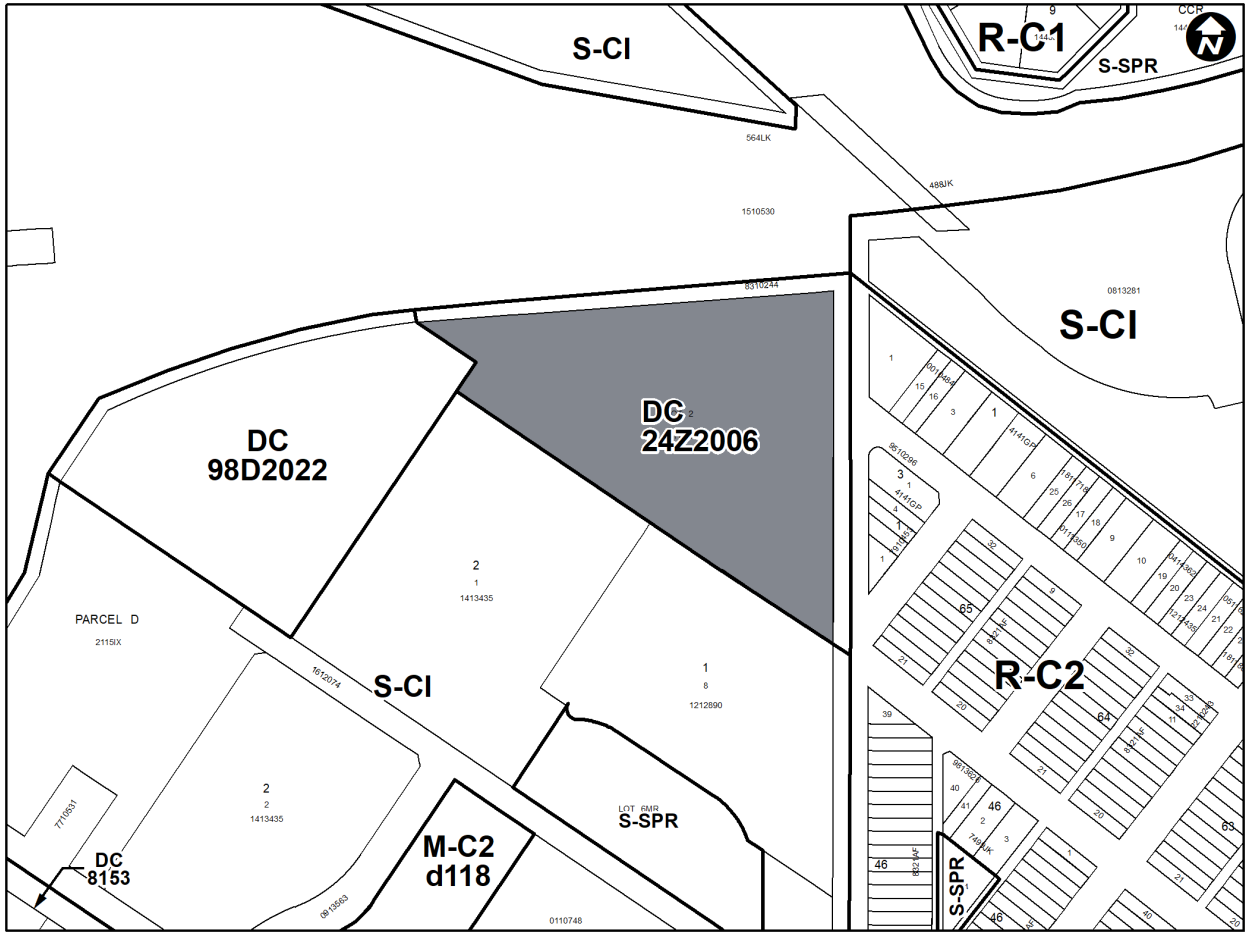
SCHEDULE A

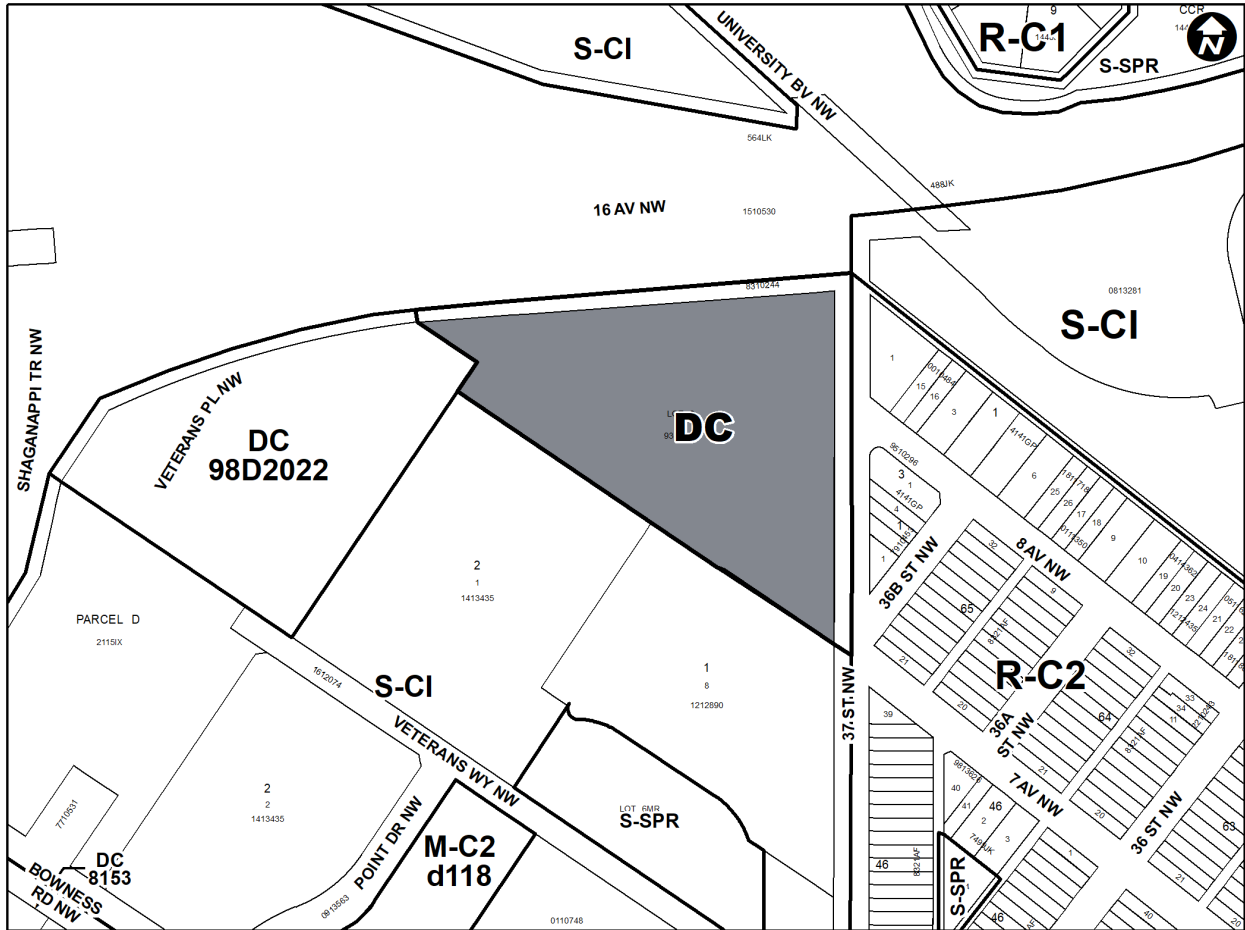

SCHEDULE B



DIRECT CONTROL DISTRICT

Purpose

- 1 This Direct Control District Bylaw is intended to allow for the additional use of Children’s Health Centre.

Compliance with Bylaw 1P2007

- 2 Unless otherwise specified, the rules and provisions of Parts 1, 2, 3 and 4 of Bylaw 1P2007 apply to this Direct Control District Bylaw.

Reference to Bylaw 1P2007

- 3 Within this Direct Control District Bylaw, a reference to a section of Bylaw 1P2007 is deemed to be a reference to the section as amended from time to time.

Defined Uses

- 4 In this Direct Control District:

(a) “Children’s Health Centre” means a *use*:

**AMENDMENT LOC2022-0182/CPC2023-0079
BYLAW NUMBER 43D2023**

- (i) where social, physical or mental care is provided to children who live full-time in the facility;
- (ii) that has at least one staff person at the facility at all times when at least one resident is within the facility;
- (iii) that may provide programming for the social, creative, educational and physical development of children;
- (iv) that may include temporary accommodations for family or guardians; and
- (v) that may include the administrative functions associated with the **use**.

Permitted Uses

5 The **permitted uses** of the Multi-Residential – Contextual Grade-Oriented (M-CG) District of Bylaw 1P2007 are the **permitted uses** in this Direct Control District.

Discretionary Uses

6 The **discretionary uses** of the Multi-Residential – Contextual Grade-Oriented (M-CG) District of Bylaw 1P2007 are the **discretionary uses** in this Direct Control District with the addition of:

- (a) **Children’s Health Centre.**

Bylaw 1P2007 District Rules

7 Unless otherwise specified, the rules of the Multi-Residential – Contextual Grade-Oriented (M-CG) District of Bylaw 1P2007 apply in this Direct Control District.

Use Rules

8 The maximum number of residents for a **Children’s Health Centre** is 50.

Building Height for Children’s Health Centre

9 The maximum **building height** for a **Children’s Health Centre** is 15.0 metres.

Required Motor Vehicle Parking Stalls for Children’s Health Centre

10 The minimum number of **motor vehicle parking stalls** for **Children’s Health Centre** is 1.0 **motor vehicle parking stalls** per three residents.

Required Bicycle Parking Stalls for Children’s Health Centre

11 There is no requirement for **bicycle parking stalls – class 1** or **class 2** for **Children’s Health Centre**.

Relaxations

12 The **Development Authority** may relax the rules contained in Sections 7 through 10 of this Direct Control District Bylaw in accordance with Sections 31 and 36 of Bylaw 1P2007.