

Before you apply:

- Visit Calgary.ca/suites to find more information on rules, requirements and to estimate your fee
- For help with your drawings visit Calgary.ca/suites to view our sample drawings [here](#)
- Please do not include personal information on plans

STEP 1: Planning Approval (Development Permit)

- Use the **property information tool** to determine your land use district and review the section “**What rules does my property have for suites**” found at Calgary.ca/suites
- If a secondary suite is listed as a permitted use and meets the suite requirements listed in the district, or you have completed this step, proceed to **Step 2: Building Safety Approval (Building Permit)**. If not, provide the information below

Supporting Documents

- A. Completed [Application Form](#) (Do not fill out if applying online)
- B. Completed [Abandoned Well Declaration](#)
- C. Completed [Public Tree Statement](#)

Plans

- D. One (1) copy of a **Site Plan**

Your **Site Plan** should include the following:

- 1 Address
- 2 Property lines
- 3 Names of adjacent city streets
- 4 Outline and dimensions of the home and any other buildings on the property
- 5 Distance from the property lines to the house
- 6 Location of all exterior stairs
- 7 Location of all parking stalls on the parcel and label stall to be used for the secondary suite (indicate size and material of parking stall(s))
- 8 Location and dimensions of the outdoor amenity space for the suite

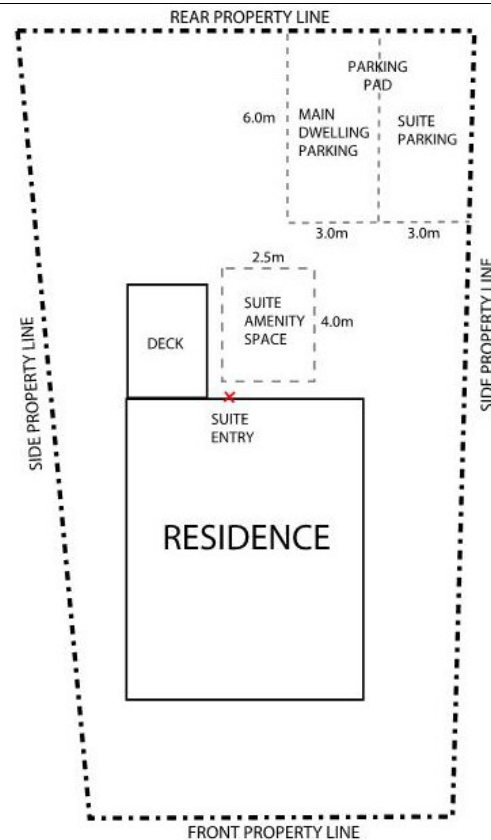

Tip: you can modify a Real Property Report (RPR) to use as your Site Plan

- E. One (1) copy of a **Floor Plans**

Your **Floor Plans** should include the following:

- 1 Address
 - 2 Layout of **each** floor of the house (i.e. basement, main floor, upper floor(s))
 - 3 Label the purpose of each room (i.e. kitchen, bathroom)
 - 4 Location of all windows and exterior doors (indicate the size, type and operation)
 - 5 Area of the secondary suite (i.e. square footage)
-

F. One (1) copy of Elevations

Your **Elevations** should include the following:

- 1 Height and width of the entire existing house
 - 2 Location of all windows and exterior doors (indicate the size, type and operation)
 - 3 If applicable, locations of all exterior stairs (above and/or below the ground)
-

STEP 2: Building Safety Approval (Building Permit)

Supporting Documents

- A. Completed **Application Form** (Do not fill out if applying online)
 - B. Completed **Asbestos Abatement Form** - This is only needed if your house was constructed **before 1990**
-

Plans

- C. One (1) copy of a **Site Plan** – refer to **Step 1, Item D** for drawings requirements
 - D. One (1) copy of a **Floor Plans** - refer to **Step 1, Item E** for drawings requirements
-

In addition to the above drawings requirements, please provide the following information on your Floor Plans:

- 1 Locations of separate ventilation and heating for the main dwelling unit and the suite
-

- E. One (1) copy of a **Elevations** - refer to **Step 1, Item F** for drawings requirements
-

NOTE: The Development Authority or Safety Code Officer may require additional materials considered necessary to properly evaluate the proposed development (as stated in Part 2, Section 26(3) of Land Use Bylaw 1P2007, Section 6(1) of Bylaw 64M94 and Alberta Building Code 2014)